

11. Planning Area 11: Open Space Buffer

- o Area: 0.2 acres
- o Permitted Uses/Development Standards: Permitted uses and development standards shall be the same as those contained in Article VIIIe of Ordinance No. 348.
- o Description: Planning Area 11 is a landscape buffer between multi-family residential area and single-family residential area. Surrounding proposed land uses include medium density residential to the north and west, multi-family residential to the east and single family dwellings within the Rancho Bella Vista Specific Plan to the south (see Exhibit No. 36).
- o Procedures: Concurrent with plot plan and/or tentative map applications for Planning Area 7, the landscape buffer treatment for Planning Area 11 must also be submitted for review and approval by the Riverside County Planning Director.

Planning Area 10 and 11

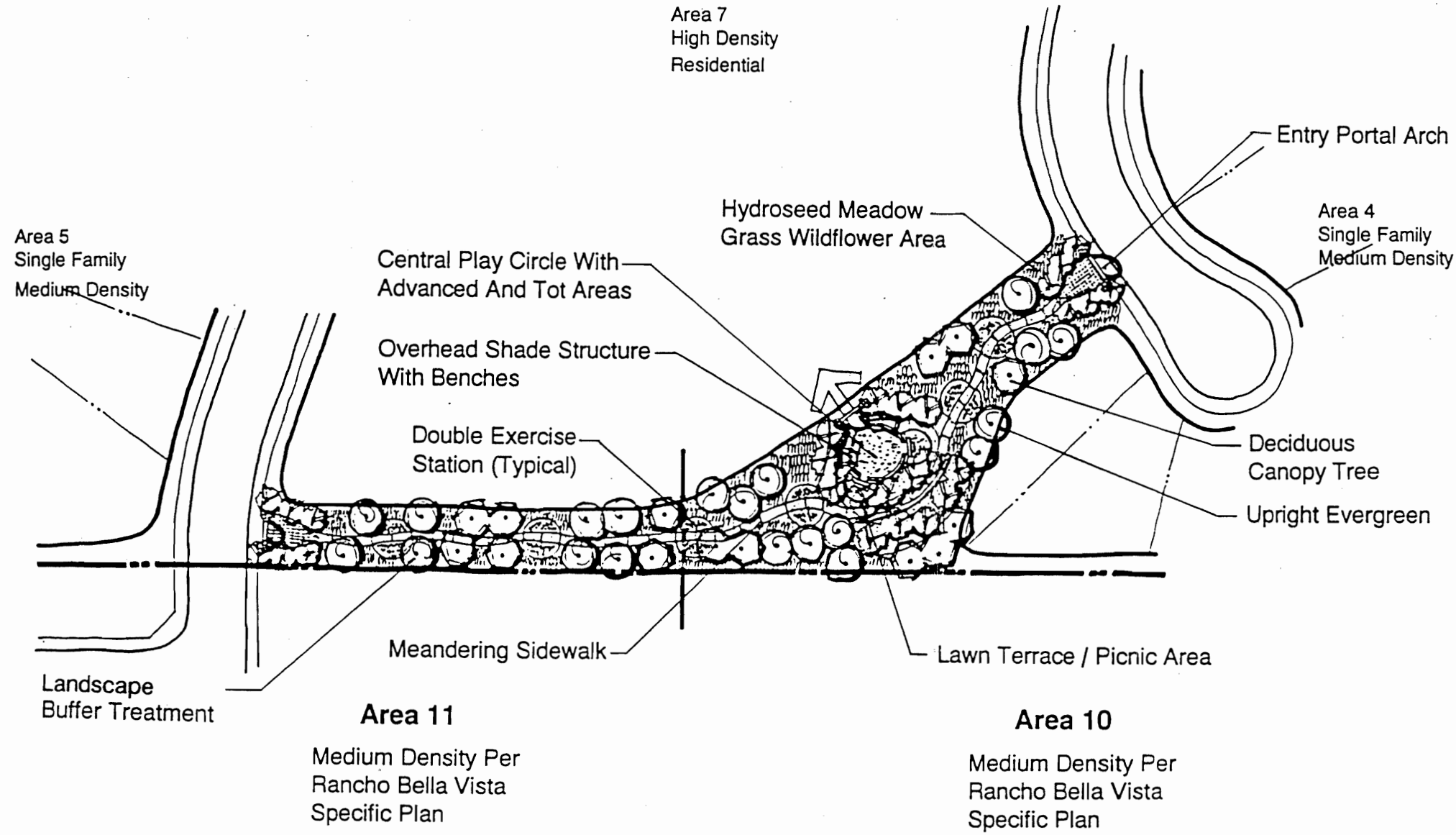
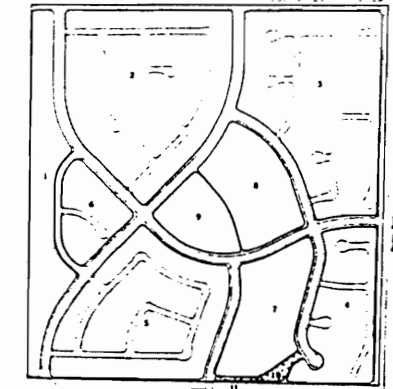

Crown Valley Village



Exhibit No.: 35 & 36