

# GAVILAN HILLS GOLF COURSE

## SPECIFIC PLAN NO. 308 LAND USE PLAN



### SPECIFIC PLAN DESIGNATIONS

#### LAND USE SUMMARY

1.	GOLF COURSE	325.4 ACRES
2.	FUTURE DEVELOPMENT	486.8 ACRES
3.	GAVILAN PEAK	55.5 ACRES
4.	OAK GROVE	12.3 ACRES
TOTAL		880.0 ACRES

#### LAND USE SUMMARY

Holes 1-9 & Practice Range	114.5 ac.
Holes 10-18	97.4 ac.
Holes 19-27	107.0 ac.
Clubhouse & Parking	5.1 ac.
Maintenance Area	1.4 ac.
<b>Total</b>	<b>325.4 ac.</b>
Entry Road	6500 ft

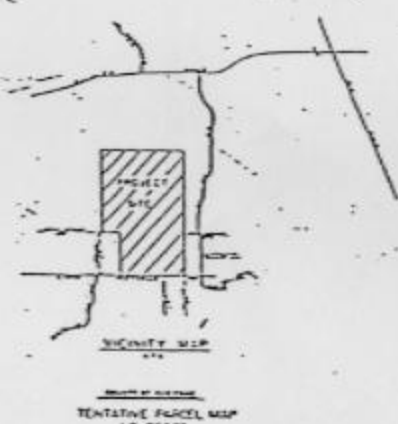

### GAVILAN HILLS GOLF COURSE MASTER PLAN

PREPARED FOR:  
INLAND PLANNING SERVICES  
3532 East Florida Ave. Suite 20  
Hemet, CA 92343  
TEL (909) 433-4303 FAX (909) 433-4224

PREPARED BY:



DATE: JUNE 14, 1987

GRAPHIC SCALE: 1"=200'

Exhibit 3